

※ Spider Robot

ID MAP

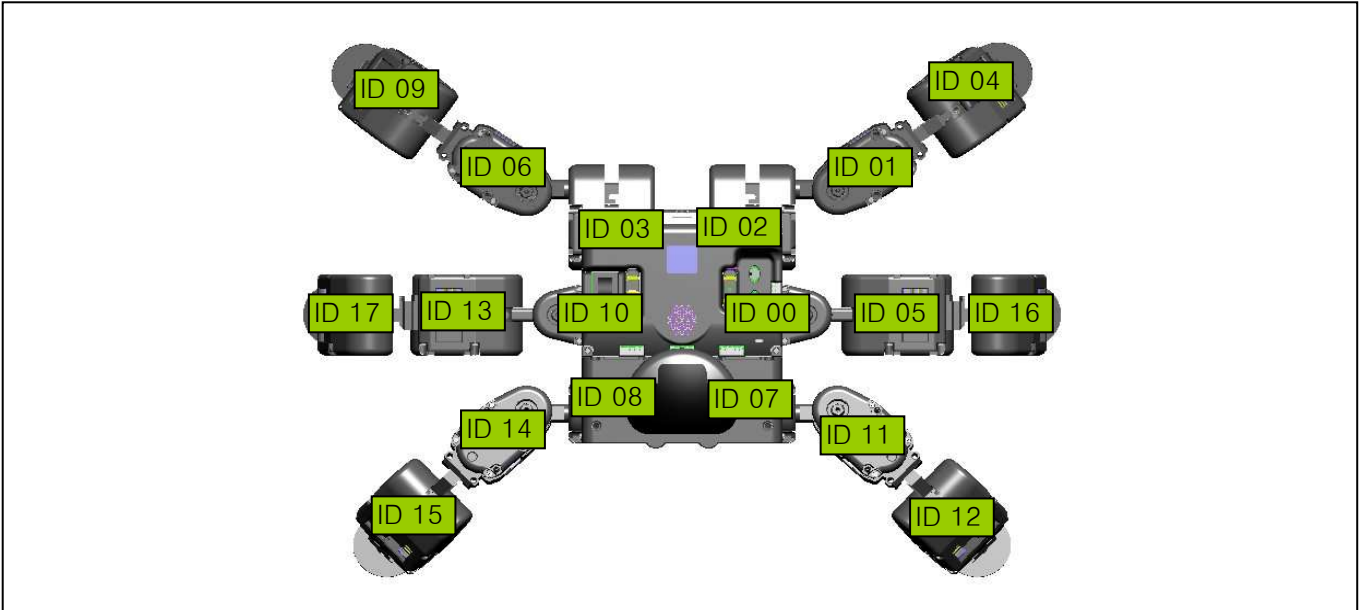

Part List

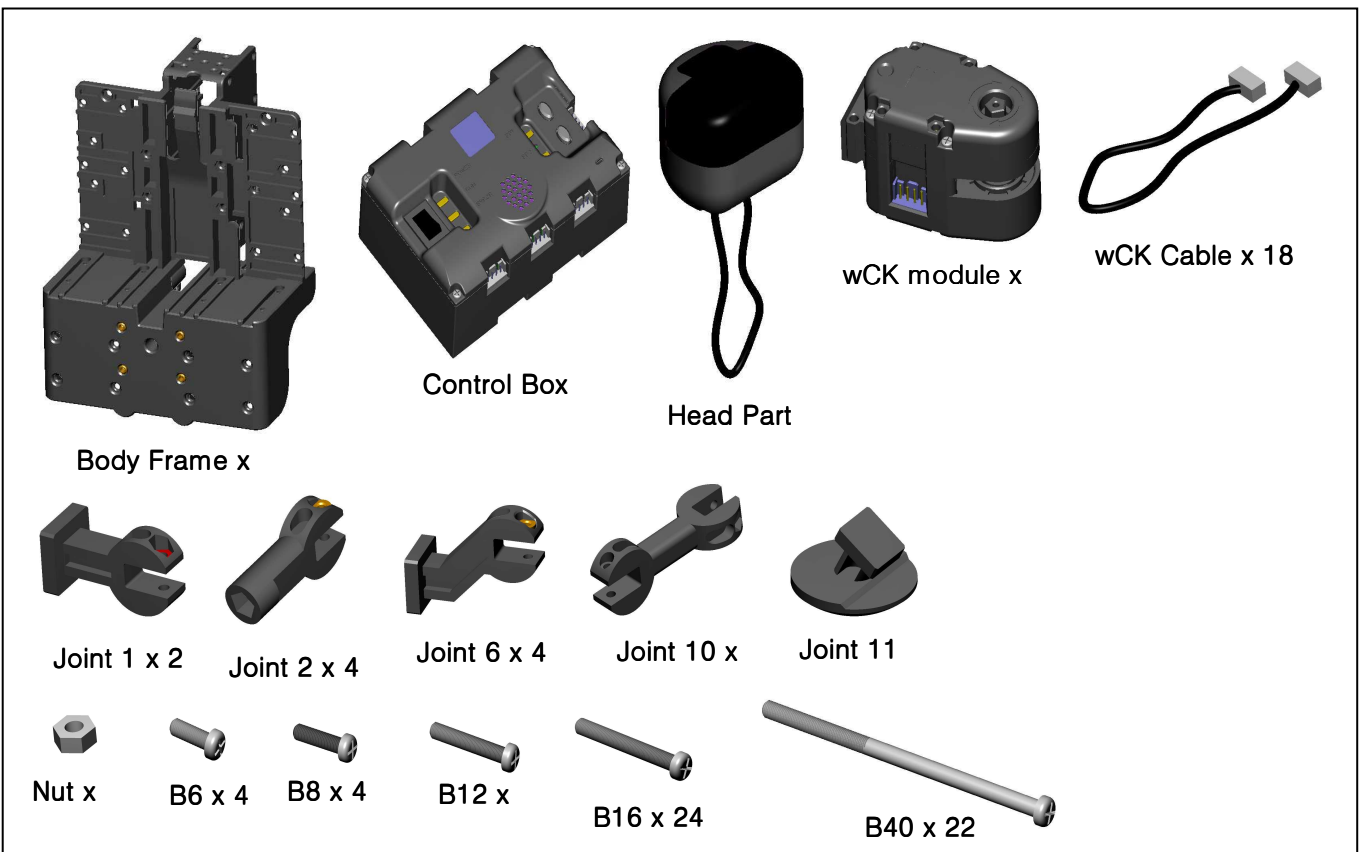

STEP 01

Sensor

Bolt M2x6L : 4EA

Nut M2 : 4EA

Bolt M2x12L : 2EA

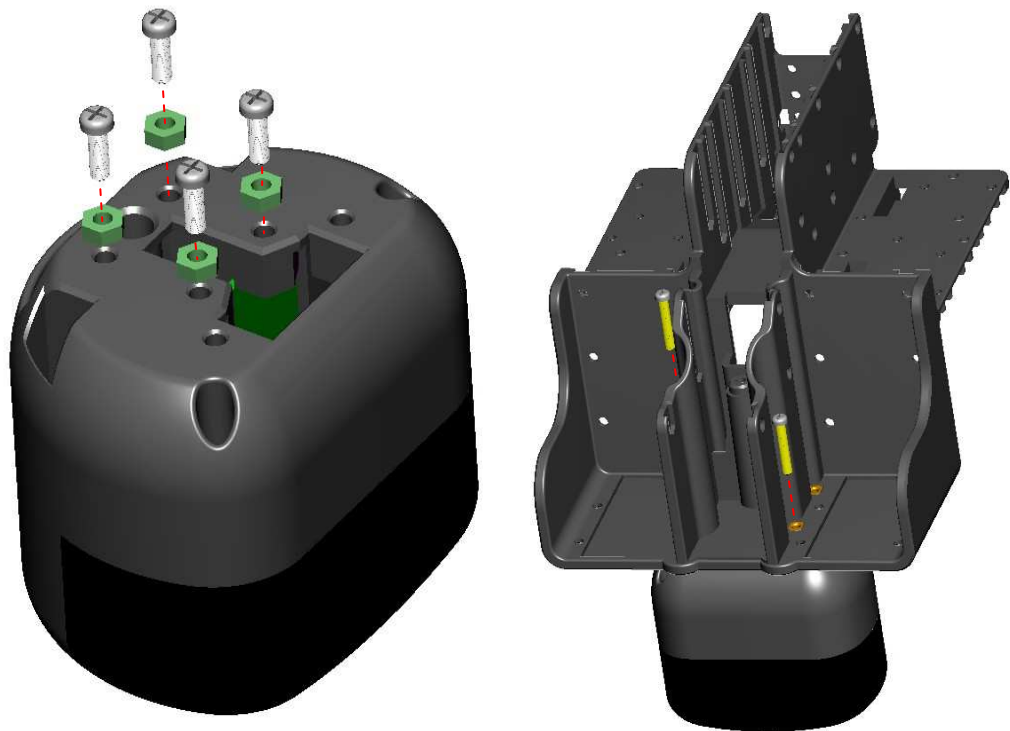

STEP 02

Left Leg

Bolt M2x40L : 3EA

Nut M2 : 3EA

Bolt M2x8L : 1EA

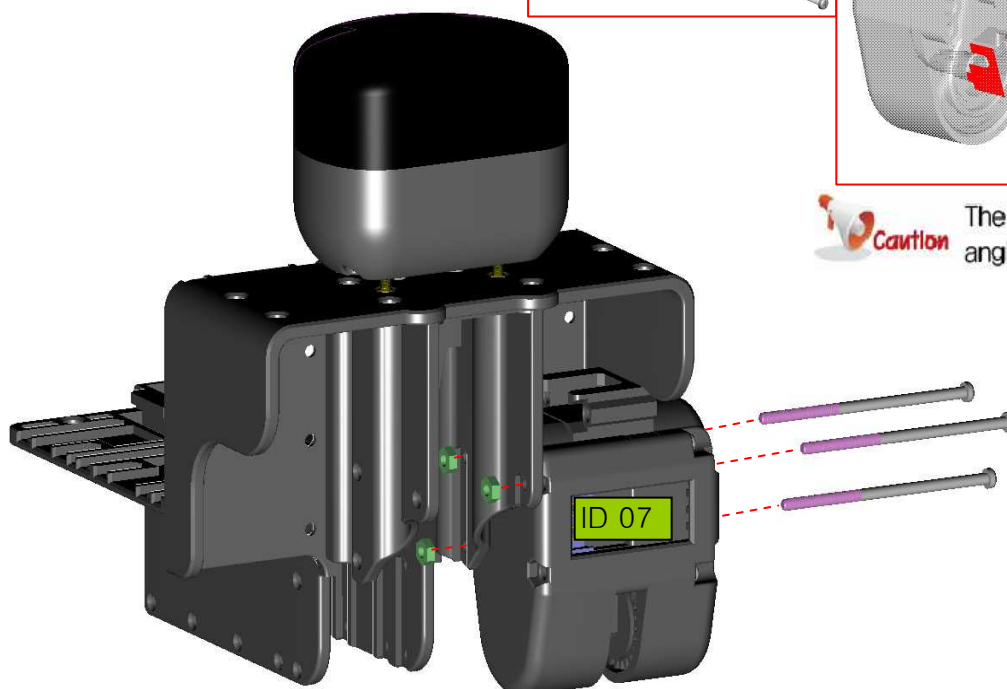

STEP 03

Left Leg

Bolt M2x16L : 4EA
Nut M2 : 4EA
Bolt M2x12L : 2EA

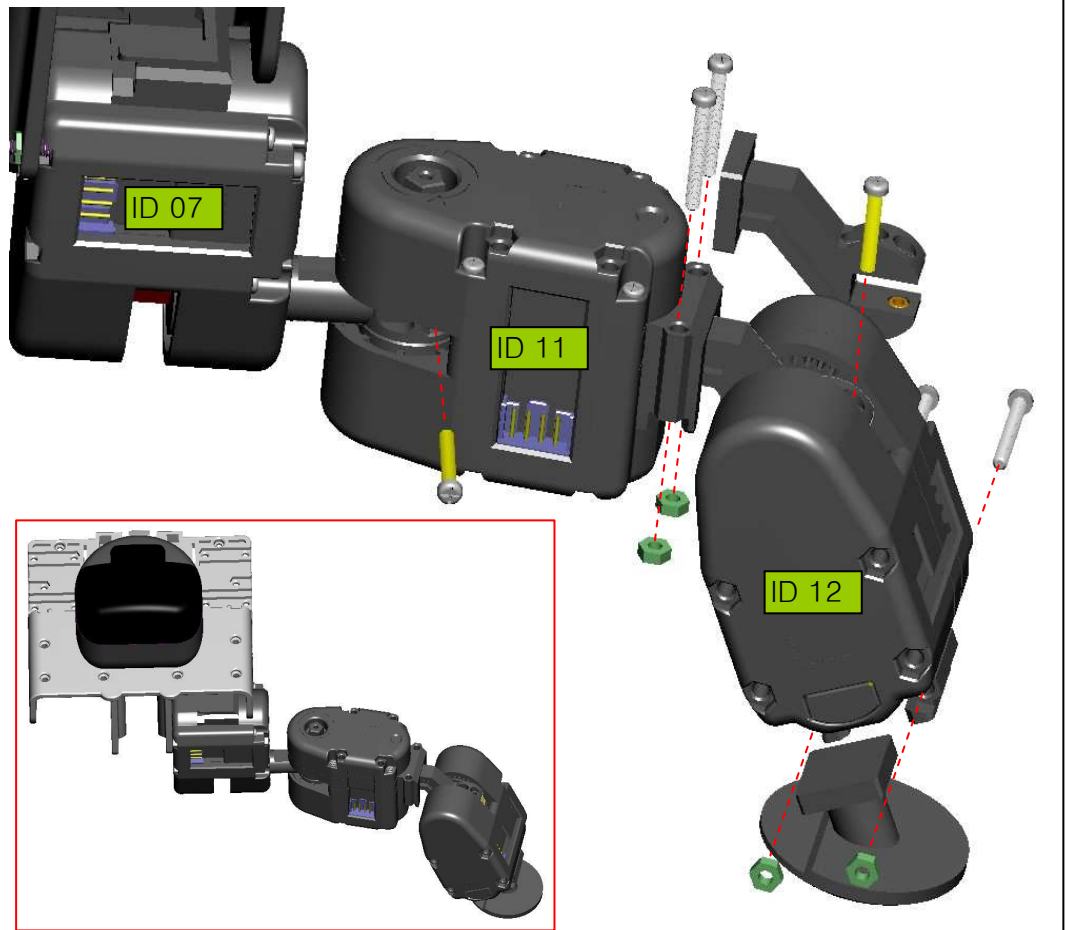

STEP 04

Right Leg

Bolt M2x40L : 3EA
Nut M2 : 3EA
Bolt M2x8L : 1EA

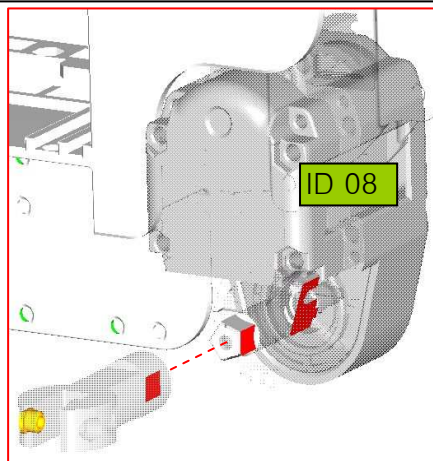

The adjustment of the connecting angle is critically important.

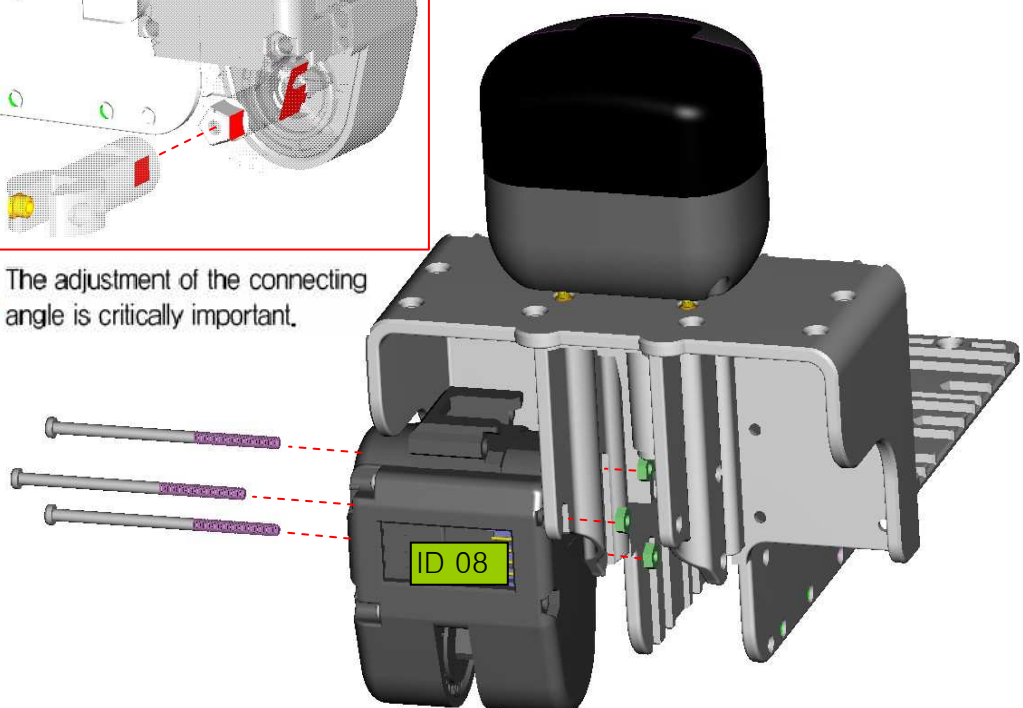
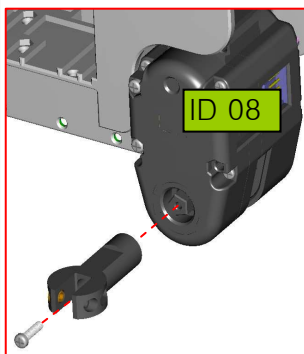

STEP 05

Right Leg

Bolt M2x16L : 4EA

Nut M2 : 4EA

Bolt M2x12L : 2EA

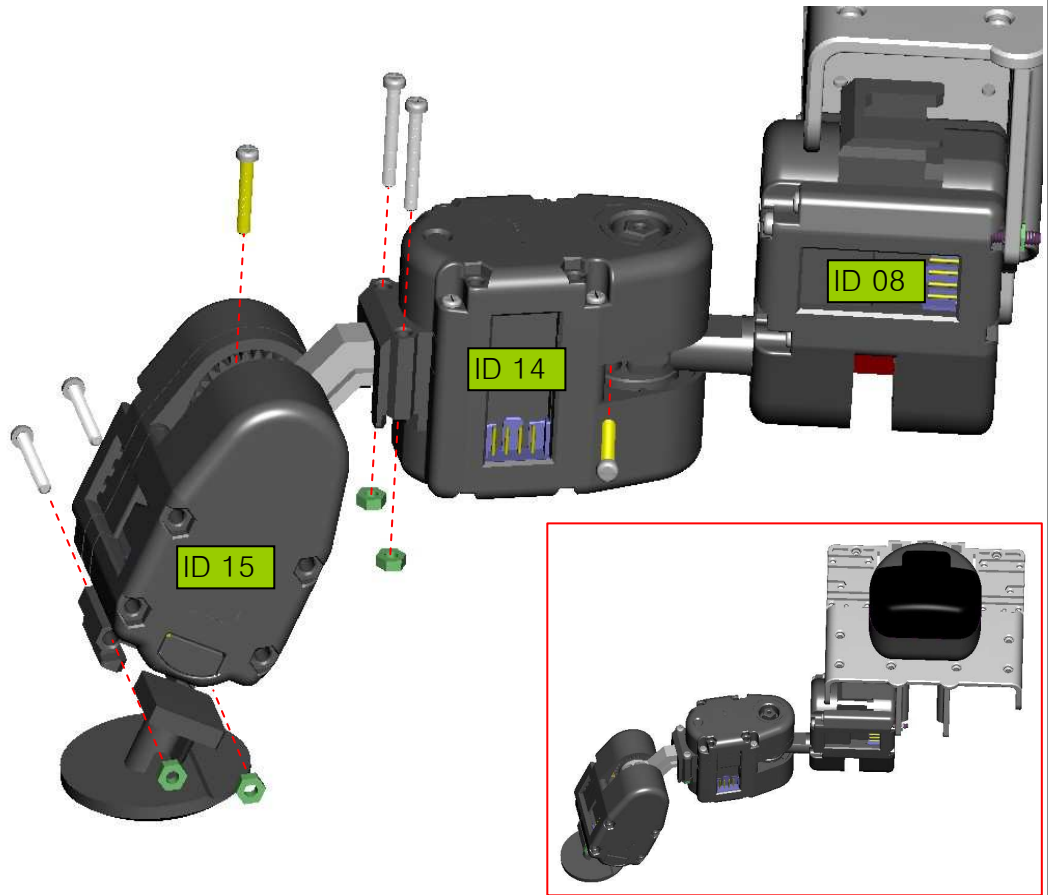

STEP 06

Middle Leg

Bolt M2x40L : 3EA

Nut M2 : 11EA

Bolt M2x12L : 3EA

Bolt M2x16L : 4EA

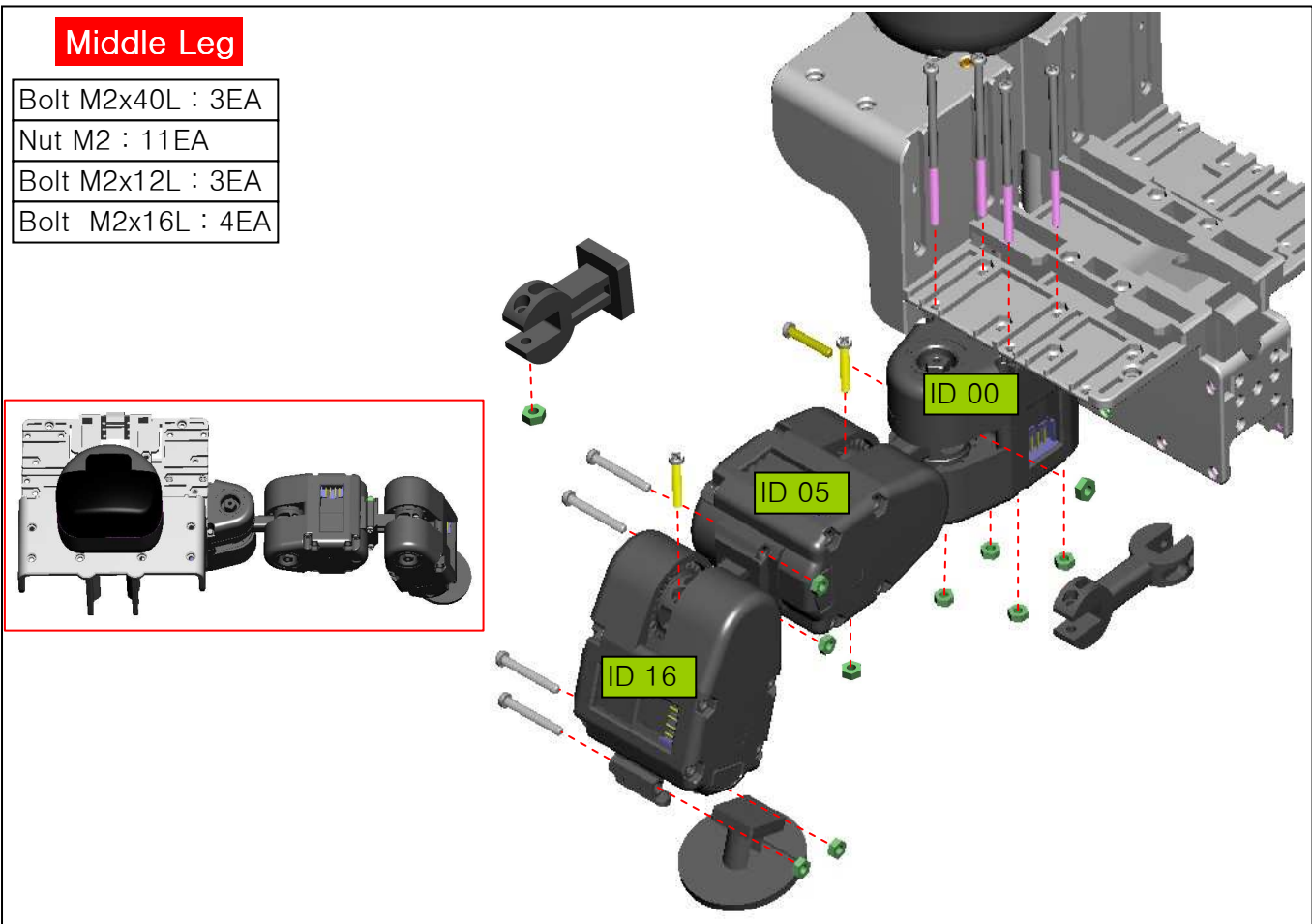

STEP 07

Middle Leg

Bolt M2x40L : 4EA

Nut M2 : 11EA

Bolt M2x12L : 3EA

Bolt M2x16L : 4EA

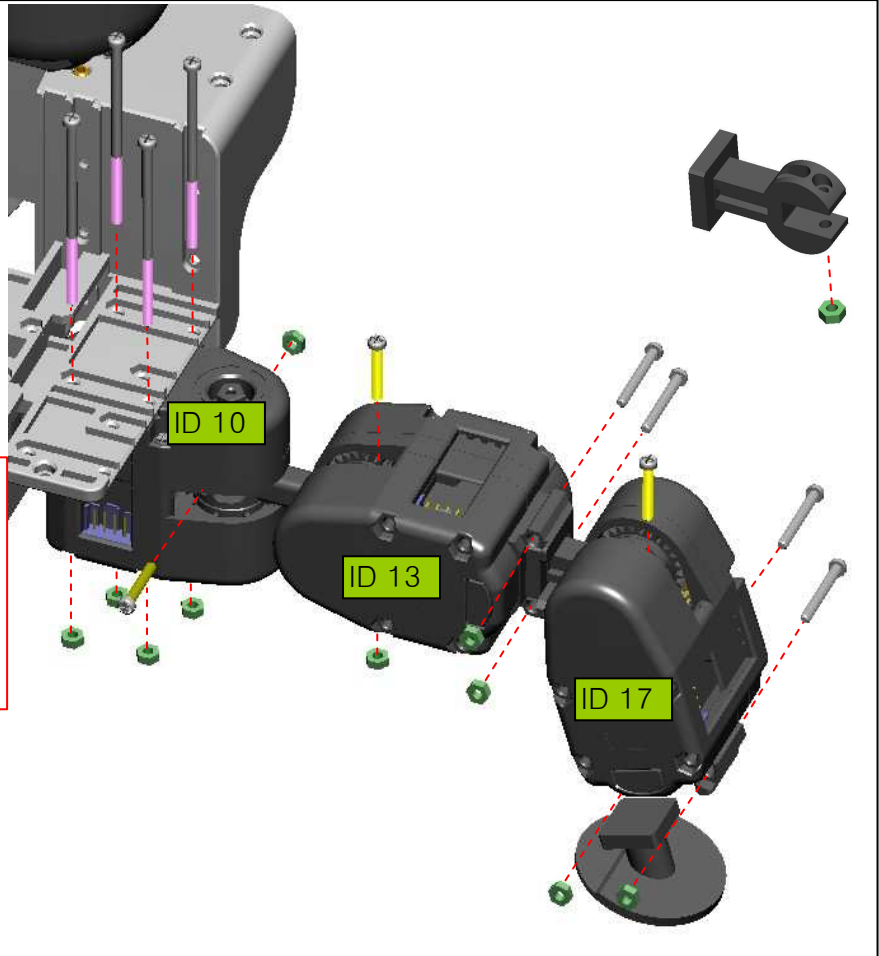
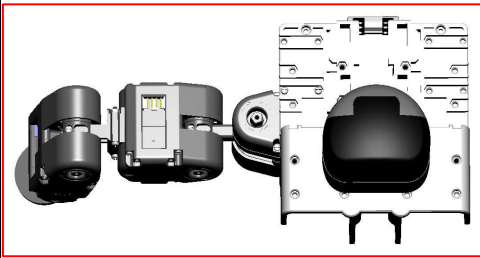

STEP 08

Left Leg

Bolt M2x40L : 4EA

Nut M2 : 4EA

Bolt M2x8L : 1EA



The adjustment of the connecting angle is critically important.

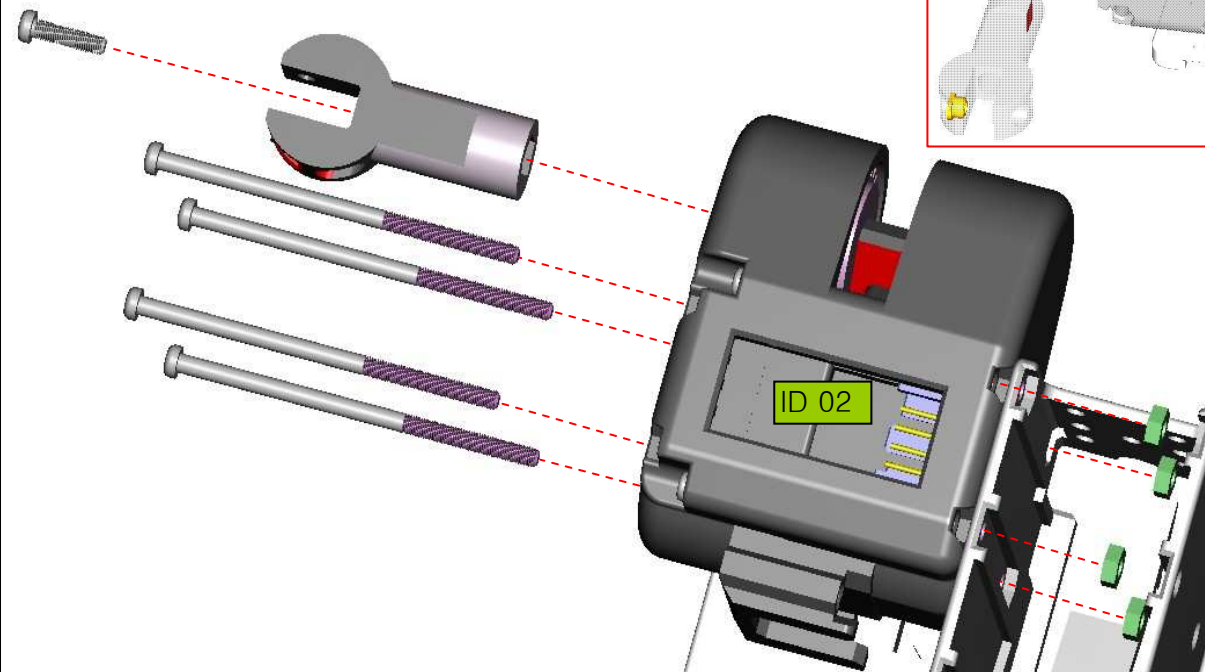
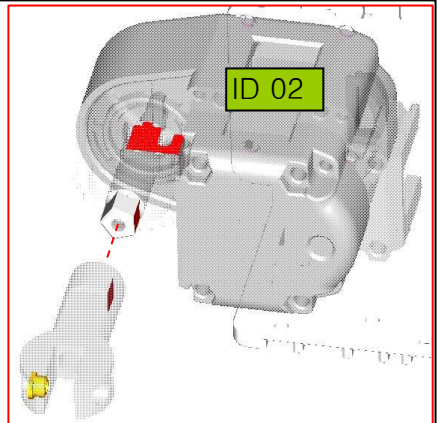

STEP 09

Left Leg

Bolt M2x16L : 4EA

Nut M2 : 4EA

Bolt M2x12L : 2EA

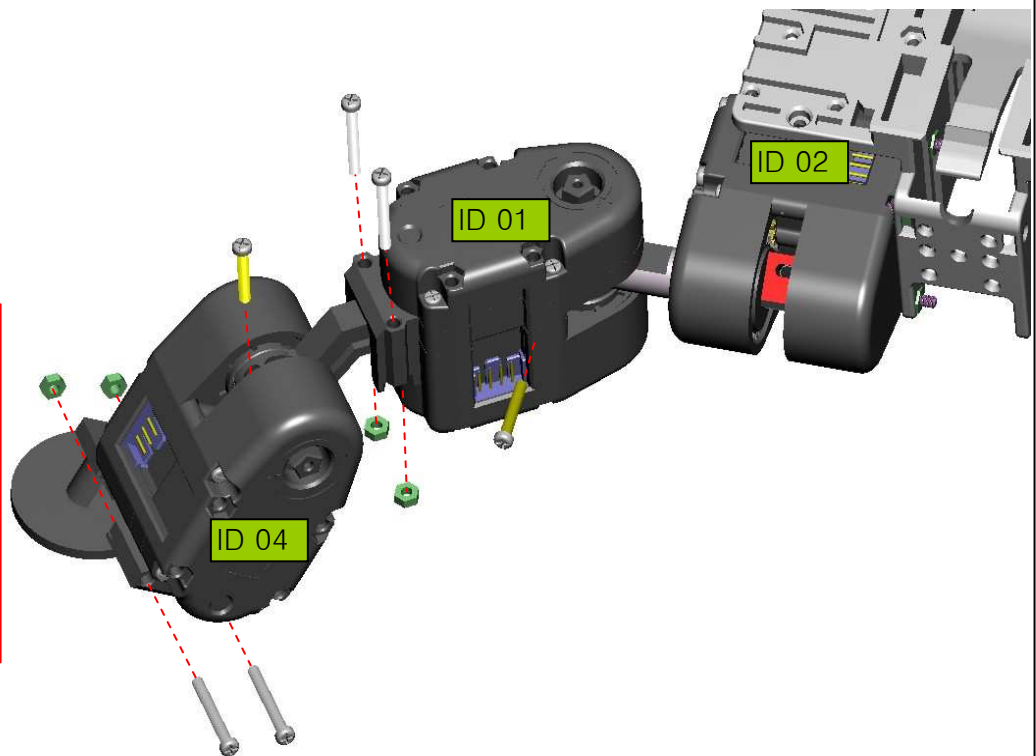
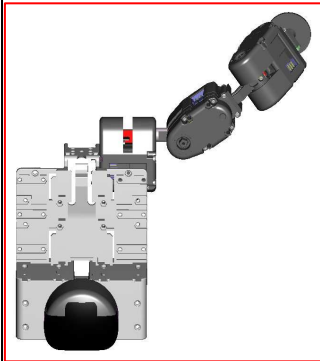

STEP 10

Right Leg

Bolt M2x40L : 4EA

Nut M2 : 4EA

Bolt M2x8L : 1EA



The adjustment of the connecting angle is critically important.

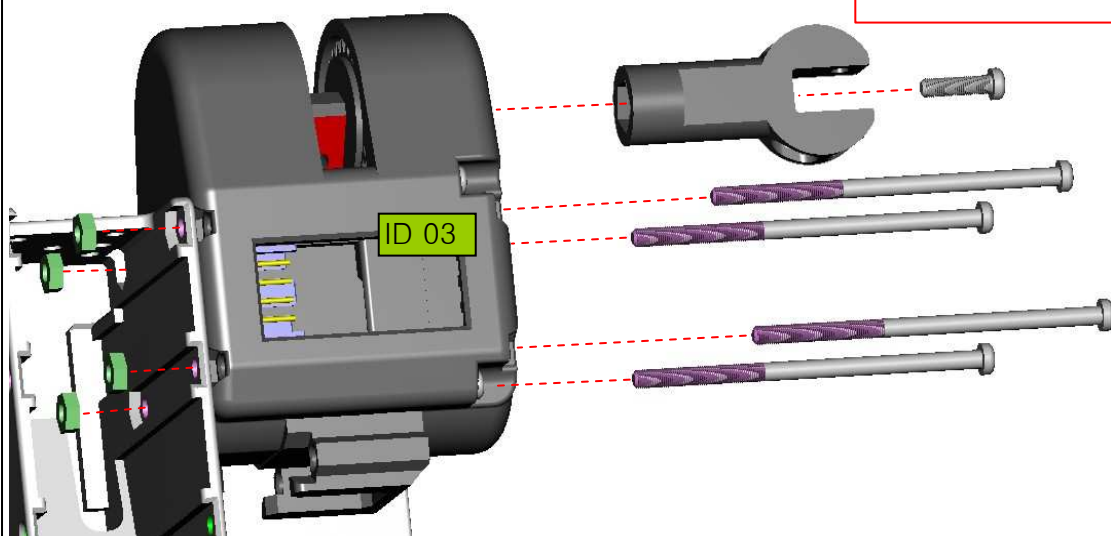
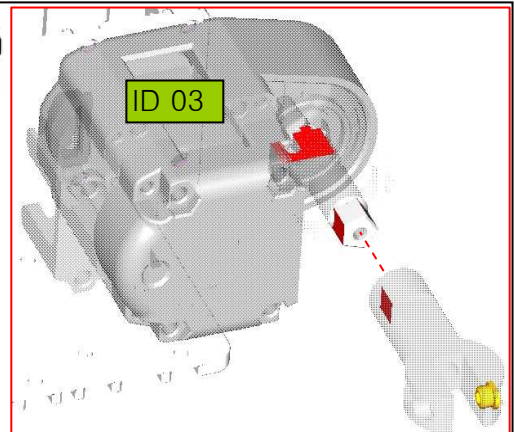

STEP 11

Right Leg

Bolt M2x16L : 4EA

Nut M2 : 4EA

Bolt M2x12L : 1EA

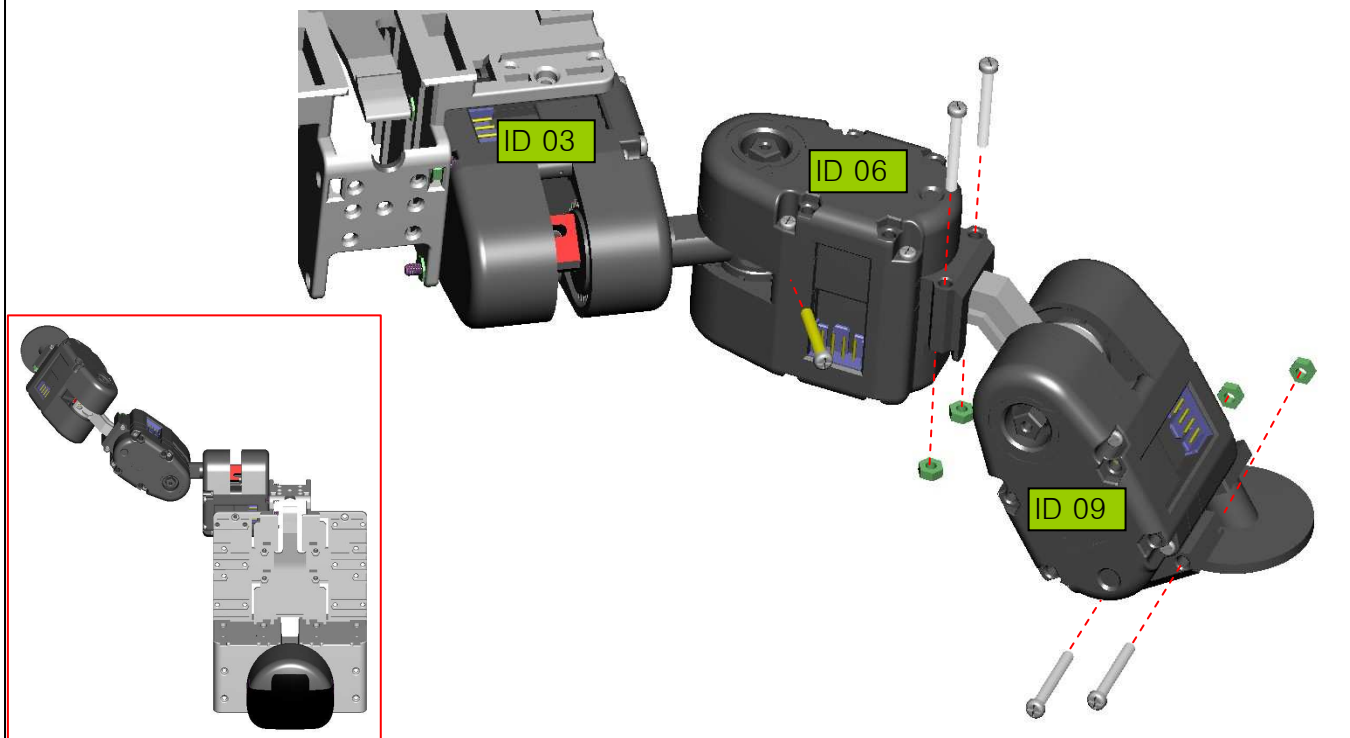

STEP 12

RBC

